



Instanta

# InstaTap

Under-Counter, Push-Button Dispensers for the office

Boiling Chilled I2BC520, all models

Boiling I2B5, all models



## Table of contents

SECTION 1 Using these instructions .....	3
Before you start .....	3
Explanation of symbols .....	3
Explanation of acronyms .....	3
SECTION 2 IMPORTANT SAFETY INSTRUCTIONS.....	4
SECTION 3 WARNINGS & REGULATORY INFORMATION .....	5
SECTION 4 Technical data .....	8
4.1 Technical data table.....	8
SECTION 5 Components supplied .....	9
SECTION 6 Installing the under counter appliances.....	10
6.1 Positioning and ventilation - all models .....	10
6.2 Pipes and tubes .....	11
6.3 General in cupboard arrangement - Boiling only models.....	11
6.4 General in cupboard arrangement - Boiling chilled models.....	12
6.5 Push fit best practice.....	13
6.6 Connect the water supply.....	14
6.7 Water block.....	16
6.8 Manifold connections and controls.....	17
6.9 Connect the electricity supply .....	18
6.10 Earth continuity test, UCB & UCC.....	19
SECTION 7 Commissioning.....	20
7.1 At first switch on .....	20
SECTION 8 Operation.....	22
8.1 Tap controls.....	22
8.2 Safety lock (enabled for boiling water only) .....	23
8.3 Dispense boiling water from the UCB .....	24
8.4 Dispense chilled water from the UCC .....	25
8.5 Adjust the chilled water flow rate from the UCC.....	25
8.6 Set up the fixed volume dispense .....	26
SECTION 9 Maintenance .....	27
9.1 Replace ,flush and reset the filter.....	27
9.1.1 Replace the FL500 filter .....	27
9.1.2 Flush the filter .....	28
9.1.3 Adjust the UCB boiling water temperature .....	29

## Table of contents

9.1.4 Set the temperature .....	29
9.1.5 Set up the UCB filter monitor .....	30
9.2 Cleaning .....	31
SECTION 10 Service warnings and troubleshooting .....	32
Environmental information .....	34
Warranty .....	35

## SECTION 1 Using these instructions

### Before you start



Read and use the instructions supplied with individual kit components for a safe installation.

### Explanation of symbols



Read the  
instructions



**WARNING**



Danger of  
electric shock



Hot surface



Highly  
flammable

### Explanation of acronyms

UCB - Under counter boiler.

UCC - Under counter chiller.

## SECTION 2 IMPORTANT SAFETY INSTRUCTIONS



### Compliance

In the UK the system must be installed in accordance with water supply byelaws, current IEEE regulations and local authority byelaws.

### Safety

This appliance is not intended for use by children under 8 years or persons (including children under 8 years) with reduced physical, sensory or mental capabilities, or lack of experience and knowledge, unless they have been given supervision or instruction concerning the use of the appliance by a person responsible for their safety. Children should be supervised to ensure that they do not play with the appliance.

### Refrigerant

**WARNING! KEEP VENTILATION OPENINGS IN THE APPLIANCE ENCLOSURE OR IN THE BUILT-IN STRUCTURE CLEAR OF OBSTRUCTION.**



The InstaTap chiller range use HIGHLY FLAMMABLE R290 refrigerant under pressure.

Check the rating plate or contact Instanta before commencing work.

Maintenance of the refrigeration unit must be carried out by an accredited service provider or qualified refrigeration technician.

Do not use mechanical devices or other means to accelerate the defrosting process, other than those recommended by the manufacturer.

### Refrigeration equipment

The chiller must be transported in an upright position.

### Qualifications

To avoid hazards, all installation procedures must be carried out by a suitably qualified tradesperson. The power cable and power outlet must be in a safe visible position for connection.

### Venting

Sometimes steam and / or boiling water droplets may discharge through the vent / overflow outlet on the InstaTap.

## SECTION 2 IMPORTANT SAFETY INSTRUCTIONS

### Lifting

Take care when lifting. The InstaTap may exceed safe lifting limits. If you feel this is beyond your personal capabilities, please seek assistance with the lift. Do not lift the InstaTap by the front cover or any of its connections.

### Airflow

The InstaTap operates within the ambient temperature range 5°C - 30°C. Proper air circulation must be provided. The system will operate satisfactorily only if the recommended air gaps are provided.

## SECTION 3 WARNINGS & REGULATORY INFORMATION

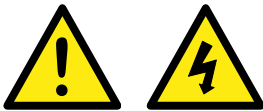

- FOR CONTINUED SAFETY OF THIS APPLIANCE IT MUST BE INSTALLED, OPERATED AND MAINTAINED IN ACCORDANCE WITH THE MANUFACTURER'S INSTRUCTIONS.
-  The InstaTap under counter boiler and under counter chiller must be earthed, earthing is provided via the supplied power cord. The resistance of the earth connection to each exposed metal part must be less than 1Ω. Use the power cable supplied. It is the responsibility of the installer to ensure the power point is earthed.
- All installation and service work must be completed by trained and suitably qualified tradespeople. Faulty operation due to unqualified persons working on this product, may void warranty coverage.
- As the installer, it is your responsibility to supply and install all valves as required by local regulations and relevant standards.
- The InstaTap is rated for 220-240V 50Hz AC operation.
- Do not remove the cover of the under counter boiler and under counter chiller without first isolating them from the power supply.

## SECTION 3 WARNINGS & REGULATORY INFORMATION

- Connect only to a potable (wholesome, cat1) mains water supply.
- Never locate the system near, or clean with water jets.
- Do not expose the InstaTap system to the elements of nature.
- A pressure limiting valve must be fitted for mains water pressures above the max. limits stated.
- Use of tools can be hazardous, assess the risks before you start.
- A clearance envelope around the under counter appliances must be provided to allow adequate ventilation and service access for their safe and effective use.
- Valve and fitting threads must be sealed appropriately with PTFE tape where compression seals are not provided.
- Do not over tighten plumbing and hose connections.
- The power cords and power outlets must be in a safe and accessible position after installation. When positioning the under counter appliances, ensure power supply cords are not trapped or damaged. If damaged they must be replaced by an Instanta service provider or a qualified electrician.
- Instanta cannot be held responsible for any appliance malfunction if the water pressure exceeds that stated. If in doubt, consult your water supply company.
- The install rail supplied must be fitted to ensure compliance with the S.I.1999 No.1148 The Water Supply (Water fittings) Regulations 1999 Schedule 2 requirement.
- Ensure that all installed silicone tubes are shaded from direct sunlight.
- Instanta cannot be held responsible for limescale related problems even when a limescale reducer has been installed.
- As with all refrigeration systems, irreparable damage can be caused by laying the chiller on its side or even transporting upside down.
- If the under counter chiller has been transported incorrectly, it should be placed in the correct upright position and left for 24 hours before attempting to install and commission it. Failure to observe these precautions could seriously damage the refrigeration system.

## SECTION 3 WARNINGS & REGULATORY INFORMATION

- All InstaTap models with chilled functionality must be sanitised during installation or the commissioning process, please contact us on 0345 6 005 005 to book a commissioning service.
- If your InstaTap is left idle before use, for water taste and quality reasons, any non-use of more than 48 hours, we recommend a system flush be performed. On first use after a period of non-use, run the chilled function for 60 seconds to flush the filter and system. Not flushing the system may affect the water quality. If taste or water quality issues persist, a filter change and sanitisation may be required.

## SECTION 4 Technical data

### 4.1 Technical data table



A 3.5 bar pressure limiting valve must be fitted for mains water pressures above 5 bar, in accordance with local plumbing regulations. (A pressure limiting valve is supplied as part of the install rail in the installation kit)

### Under counter chiller & under counter boiler

Specification	Unit	Under counter chiller	Under counter boiler
Capacity	L	N/A	5
Dimensions (W x D x H)	mm	180 x 340 x 390	230 x 415 x 510
Supply voltage	V	230 50Hz AC	230 50Hz AC
Power rating	kW	0.185	2.25
Mains water supply pressure	bar	2 - 5	2 - 5
Fill type		Automatic	Automatic
Recovery per minute	L	0.33	0.38
Water temperature	°C	5 - 9	80 - 95 (default 95)
Weight (empty)	kg	17	9.9
Weight (full)	kg	19	17.3
Heat up time from cold	mins	-	20
Mains water connection		3/4" BSP (Install rail 15mm)	3/4" BSP (Install rail 15mm)
Fuse rating	A	5	13



## SECTION 5 Components supplied

### 5.1 Supplied parts checklist

- Before starting installation check that you have the following parts.

#### Boiling (B) and Boiling Chilled (BC) models

BC	B Qty	Description
1	1	Under-counter boiler (UCB)
1	1	Instruction manual
1	-	Under-counter chiller (UCC)
1	-	3/8" push fit - equal Tee
3	2	3/8" push fit - G3/4 brass connector
1	1	Install rail & water block
3	2	1m 3/8 JG pipe
1	-	UBC - UCC interconnect cable
		<b>Under-counter chiller ventilation kit</b>
1	-	Air inlet grille & retaining screws
1	-	Air outlet grille & retaining screws
		<b>Filter kit, supplied with all office models</b>
1	1	FL500 filter
1	1	Filter head
1	1	1m length 3/8" blue JG flexible pipe
2	2	Filter head mounting screws
2	2	3/8" push fit elbow, to avoid tight tube bends

## SECTION 6 Installing the under counter appliances

### 6.1 Positioning and ventilation - all models



Use of tools can be hazardous, assess the risks before you start.



Use instructions supplied with individual kit parts.



- A clearance envelope both sides and above each under counter appliance must be provided to allow service access and ventilation for the safe and effective use of the under counter boiler (UCB) and under counter chiller (UCC).

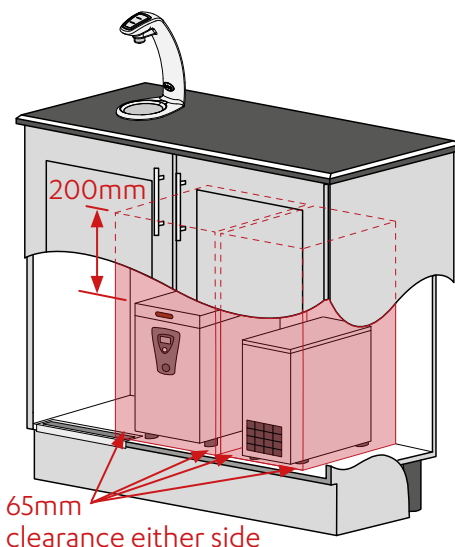

- Adequate ventilation must be provided to allow cold air to be drawn into the bottom of the cupboard, and hot air expelled from the top of the cupboard.
- **The inlet and outlet vents supplied must be installed to keep cupboard temperatures below 30°C.**
- Door buffers must be fitted to provide sufficient air flow.
- Cupboard temperatures should not exceed 30°C.

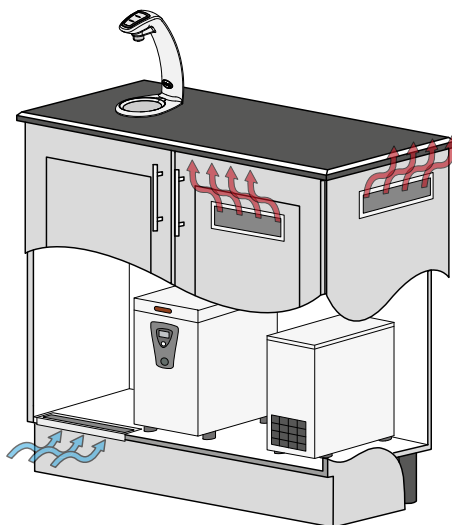

## SECTION 6 Installing the under counter appliances

### 6.2 Pipes and tubes



Install pipes & tubes correctly. No kinks, sags, pinches or loops.  
Ensure there is a constant fall from the tap down to the appliance.

### 6.3 General in cupboard arrangement - Boiling only models

- Install the tap as close to the boiler as possible, use the illustration below as a guide, and follow the steps through this section of the manual.

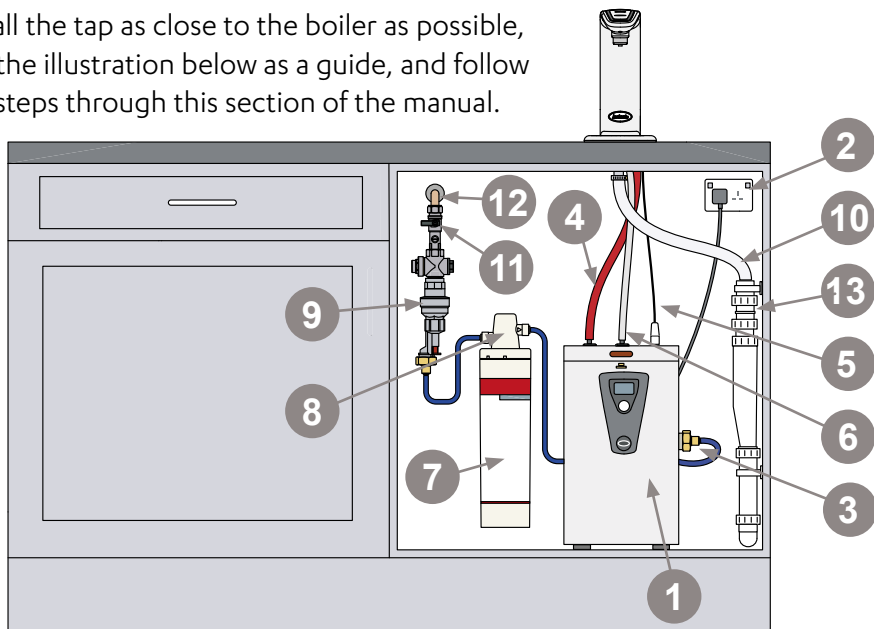

- |                                |   |
|--------------------------------|---|
| 1 Under counter boiler (UCB)   | 7 Water filter  |
| 2 UCB Mains electricity supply | 8 Filter head   |
| 3 UCB mains water connection   | 9 Water block   |
| 4 UCB Boiling water tube       | 10 Font waste pipe                                      |
| 5 UCB Control cable            | 11 Isolation valve (install rail inc. non return valve) |
| 6 UCB overflow & vent tube     | 12 Mains water supply                                   |
|                                | 13 Waste to drain                                       |

## SECTION 6 Installing the under counter appliances

### 6.4 General in cupboard arrangement - Boiling chilled models

- Install the under counter boiler and chiller as close to the tap as possible, use the illustration below as a guide, and follow the steps through this section of the manual.

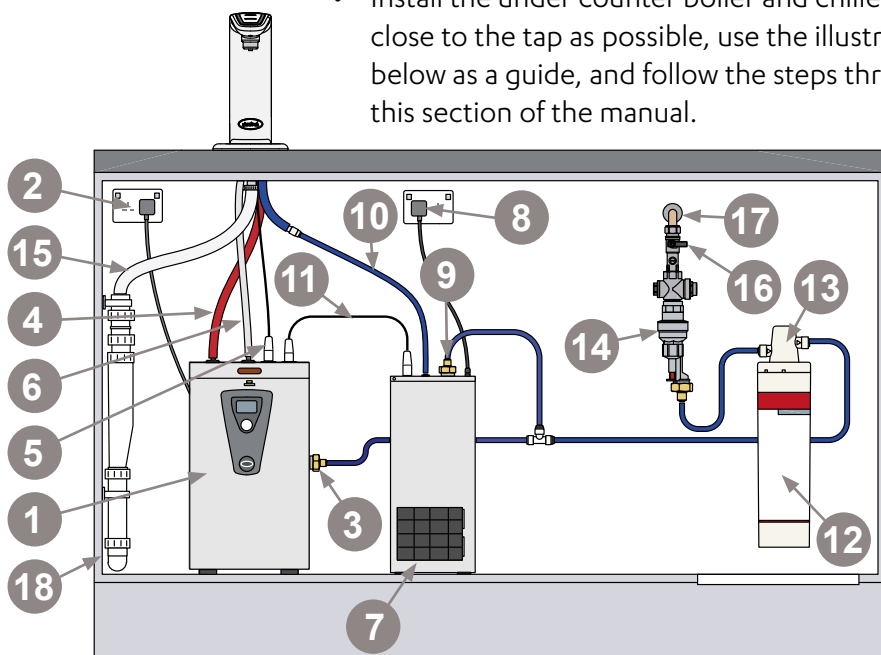

- |                                |   |
|--------------------------------|---|
| 1 Under counter boiler (UCB)   | 10 UCC Chilled water 3/8" pipe Connected to silicone tube |
| 2 UCB Mains electricity supply | 11 UCB - UCC control cable                                |
| 3 UCB mains water connection   | 12 Water filter   |
| 4 UCB Boiling water tube       | 13 Filter head  |
| 5 UCB control cable            | 14 Water block  |
| 6 UCB overflow & vent tube     | 15 Font waste pipe  |
| 7 Under counter chiller (UCC)  | 16 Isolation valve (install rail inc. non return valve)   |
| 8 UCC Mains electricity supply | 17 Mains water supply                                     |
| 9 UCC mains water connection   | 18 Waste to drain   |

## SECTION 6 Installing the under counter appliances

### 6.5 Push fit best practice

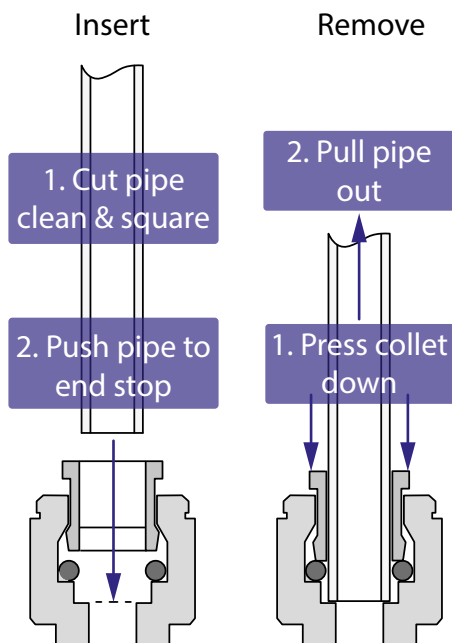

## SECTION 6 Installing the under counter appliances

### 6.6 Connect the water supply



Valves and fittings must be sealed with PTFE tape if compression seals are not included.

Water supply pressure range 2 - 5 bar.



If the mains water pressure is below 2 bar a fault could arise.

If the mains water pressure exceeds 5 bar a 3.5 bar water pressure reducing valve must be fitted. Failure to do so could result in the appliance overflowing.



To avoid damage, do not use any solder connections whilst pipes are connected to the appliance.

Instanta cannot be held responsible for any appliance malfunction if the water pressure is not within the range stated. If in doubt, consult your water supply company.



Use instructions supplied with the individual system components.

#### 6.6.1 Mains water connection

- Connect to a wholesome (cat 1) cold drinking water supply using 15mm copper pipe-work to the install rail.
- The install rail must be fitted, it includes an isolation valve to turn off the water supply for servicing or repair, as well as a back-flow prevention device to prevent water from the appliance re-entering the mains water supply.
- When installing 'push fit' fittings and pipe-work observe push fit best practice, see page 13.
- To install the filter head, use the instructions supplied with it.
- To install and set the water block, use the instructions supplied with it and refer to page 16.
- To install the FL500 filter, use the instructions supplied with it and refer to page 27.
- The filter must be flushed after installation, see page 28.

## SECTION 6 Installing the under counter appliances

### Mains water supply arrangement

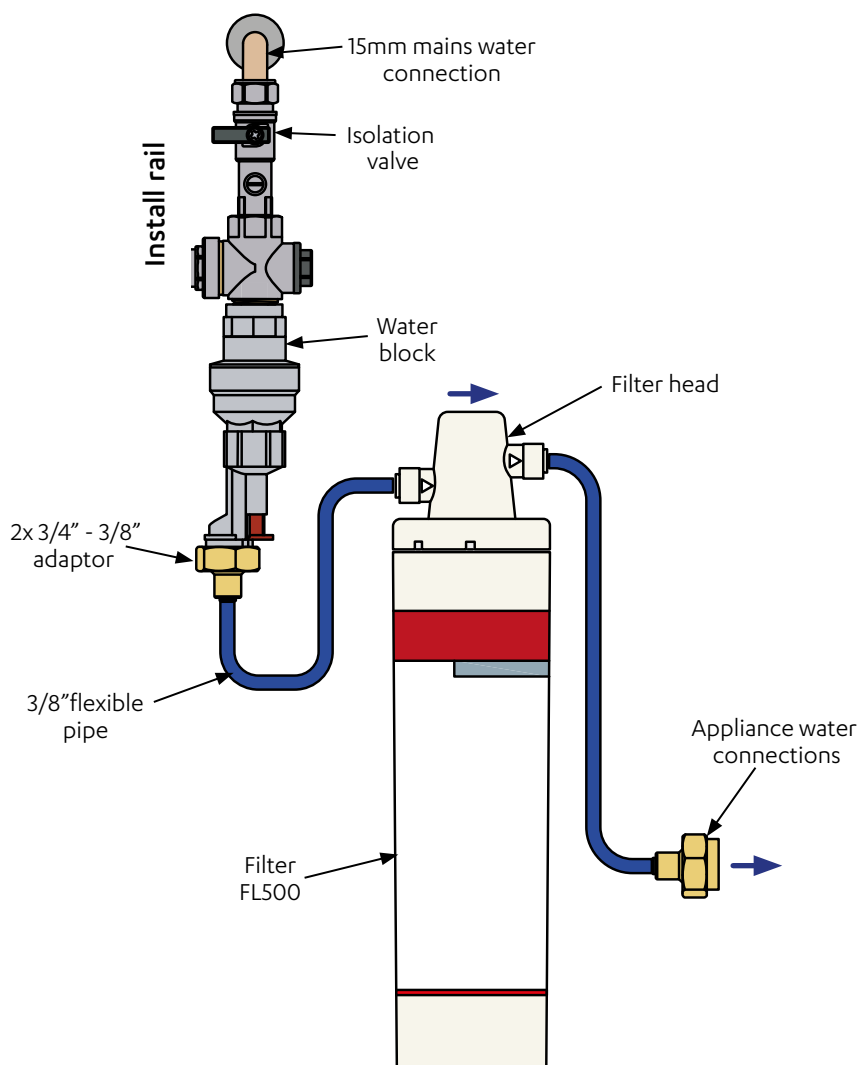

## SECTION 6 Installing the under counter appliances

### 6.7 Water block



This device must be installed vertically with the direction of flow downwards (inlet at the top, outlet at the bottom). See Fig. 1

- The Water Block should be installed in a convenient location on the water supply line to the appliance.
- Rotate Pointer 'P' (see Fig.3) until in line with the max. required flow. The number scale corresponds to 5 litres of flow i.e. 1 = 5 litres, 10 = 50 litres.
- The key (see Fig.2) should be used to adjust the pointer.
- The inlet should be connected via a 15mm copper tail.
- The outlet shall be connected via the 3/4" - 3/8" push fit brass fitting supplied.
- Ensure that the direction of flow through the Water Block is correct and that the filter screen (see Fig.2) is inserted correctly with the convex surface facing towards the water supply.

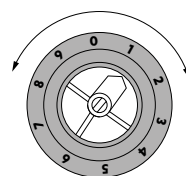
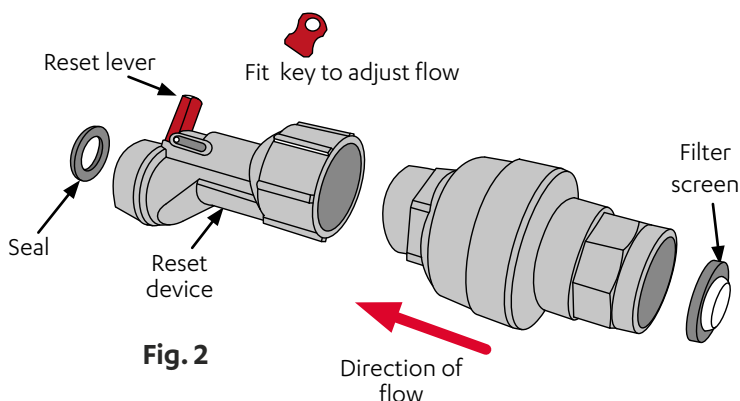
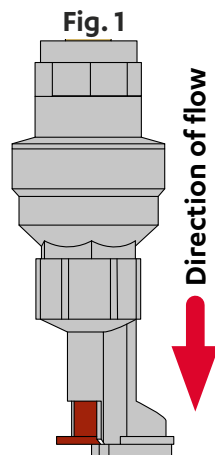

#### 6.7.1 Reset procedure

- The Water Block will activate and shut off the supply if more water than the set amount is drawn off at one time.
- In this event isolate the water supply to the Water Block.
- Identify and repair the leak then press the reset lever (Fig. 2).
- Tripping issues, contact Technical support on 0345 6 005 005 for advice.



## SECTION 6 Installing the under counter appliances

### 6.8 Manifold connections and controls

- Using the installation diagrams, see page 11-12 as a guide, connect the system together.

#### I2BC520 Boiling chilled models

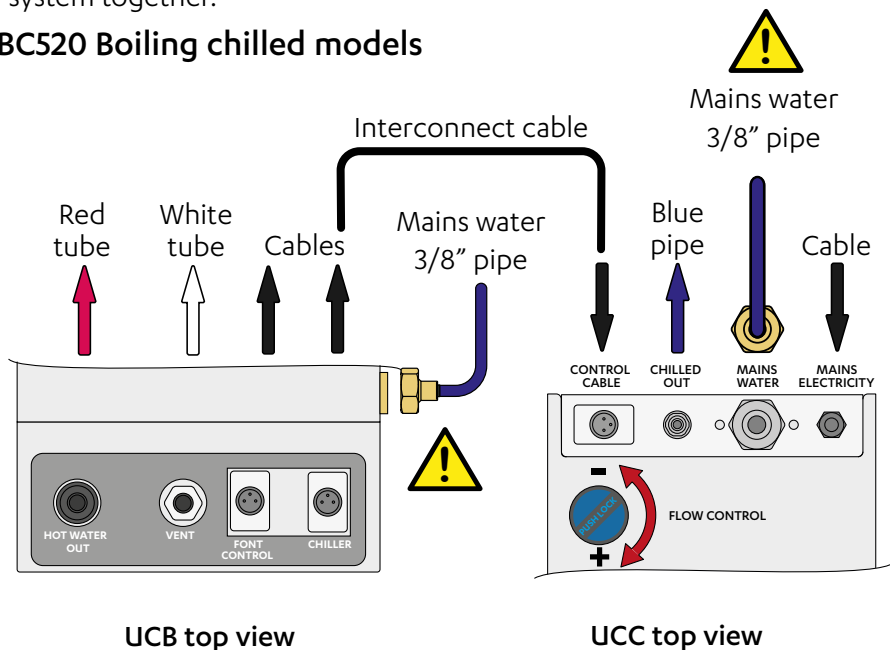

#### I2B5 Boiling models

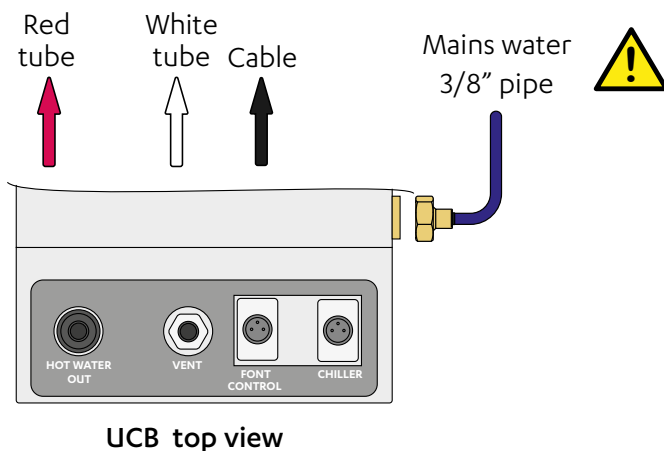

## SECTION 6 Installing the under counter appliances

### 6.9 Connect the electricity supply



Before you start read :

Section 2 Important safety instructions.

Section 3 Warnings & Regulatory information.

Do not switch on the mains electricity supply until installation is complete, all electrical /plumbing connections have been made and the earth continuity has been tested.

- Connect the mains plug to a 230V 50Hz 13A socket.

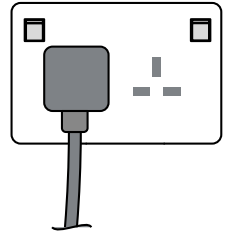

### 6.10 Earth continuity test, UCB & UCC



All accessible metal parts must be earthed.

- Before installation, the earth continuity of both the UCB & UCC must be checked. Use an insulation tester, appliance tester, DMM or continuity tester with an accuracy of Class 5 or better ( $\pm 5\%$  at full-scale deflection).

#### 6.9.1 To test the earth continuity

- Isolate the appliance from the electricity supply.
- Set the meter to the lowest ohms ( $\Omega$ ) scale and set to a reading of  $0\Omega$  with the meter probes connected together.
- Connect one of the meter probes to the earth wire of the mains cable or earth pin of the mains plug.
- Connect the second meter probe to a bare patch of metal or a screw (the edge is best) on the appliance and read the display.
- Repeat with the second test lead touching the metal body of the tap.
- All readings should be less than  $1\Omega$ .
- If any of the reading are above this value, check the earth connection inside the appliance.

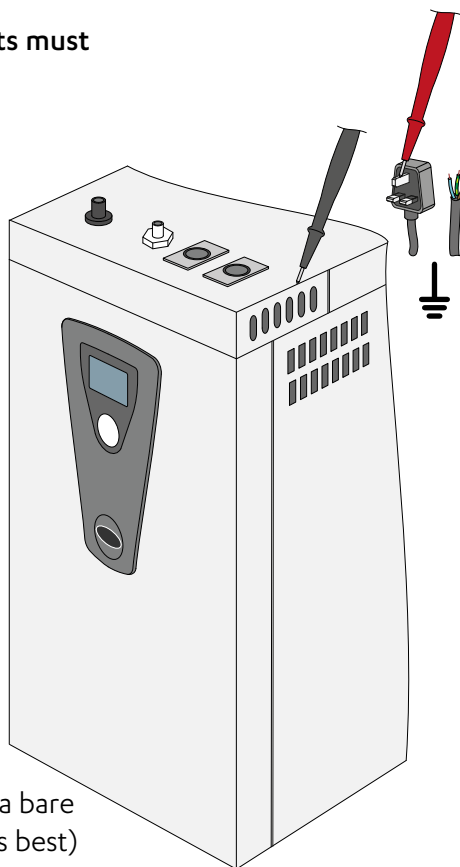

Insulation resistance meter or DMM

### 7.1 At first switch on



### Santising

- All InstaTap models with chilled functionality must be sanitised during installation or the commissioning process,
- Please contact us on 0345 6 005 005 to book a commissioning service.

#### 7.1.1 Under counter boiler (UCB)

- Flush the filter, see page 28.
- Turn on the mains water supply.
- Switch on the mains electricity supply.  
In a Boiling chilled system, always switch the UCB on first, then the UCC, as the UCB controls the UCC.
- Switch on the UCB by pressing the ON/OFF button on the display panel.
- The system runs through an initial self diagnostic check, various messages are displayed on the screen.
- The tank fills.
- NOT READY, FILLING, --°C" is displayed.
- If the tank does not fill to its pre-set level within 6 minutes CHECK WATER is displayed.
- If this happens, check that the isolation valve is turned on, there are no kinks in the inlet hose and that the Water Block doesn't need to be reset.
- If these are in order, check that the filters in the Water Block and water connection point are not clogged with debris.

ON/OFF  
button

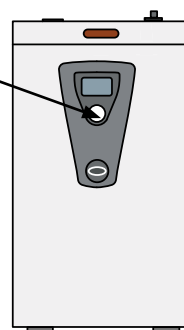

UCB

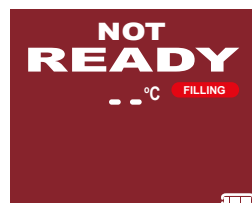

## SECTION 7 Commissioning

- To clear the warning, switch off the UCB mains electricity supply, and then switch back on.
- When the water level reaches the boiler's bottom sensor, the heater is switched on.
- NOT READY, HEATING, --°C is displayed.
- When the water temp is close to the programmed temperature, the real time temperature is displayed.
- When the programmed temperature has been reached, READY, CAUTION HOT WATER, (TEMP)°C is displayed.
- The red background illumination is extinguished.
- The tap controls illuminate.
- The UCB does not fill completely at once. The water input is electronically controlled to obtain maximum output, temperature and efficiency.
- Dispense (see page 24) 3 litres of water to flush the UCB system.
- Wait again for the screen to read READY before making a drink.



**IMPORTANT NOTE** In daily use you may use the appliance as soon as the tap controls illuminate but on first installation wait at least 10 minutes before starting to use the water.

### 7.1.2 Under counter chiller (UCC)

- Flush the filter, and sanitise the system, see page 28.
- Turn on the mains water supply.
- Switch on the mains electricity supply.
- Using the chilled water button on the tap control panel, see page 25, dispense 3 litres of water to prime and flush the UCC system.
- Wait 30 minutes, the fan and compressor will turn off indicating that the UCC has reached its normal operating temperature and is ready for use.

### 8.1 Tap controls

#### Warning symbol

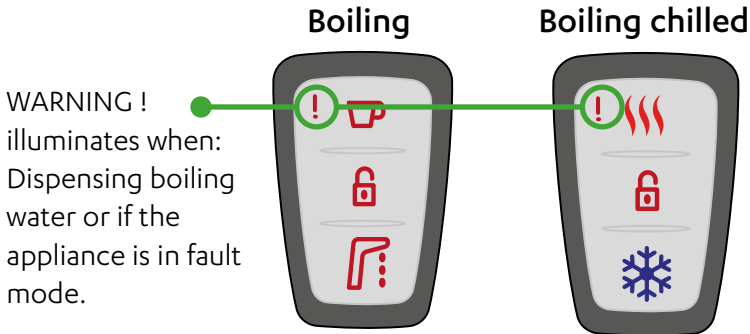

- The exclamation mark on tap flashes when in fault mode, at the same time warning triangle flashes on appliance display screen.

#### Dispense and safety controls

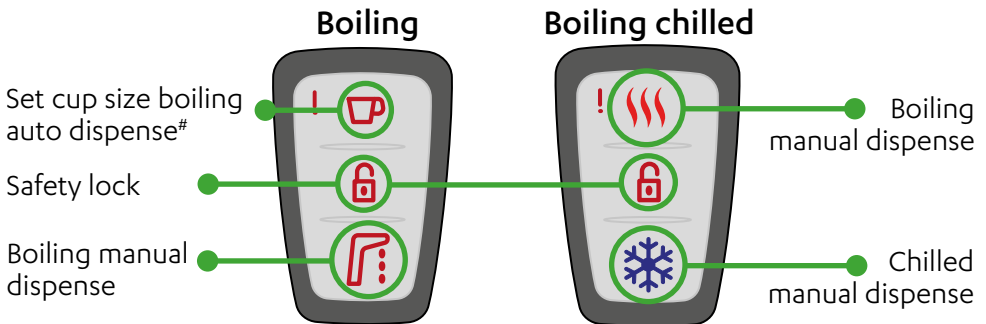

- #To set the fixed dispense volume, see page 26.

## SECTION 8 Operation

### 8.2 Safety lock (enabled for boiling water only)

- The safety lock is enabled by default.
- The safety lock is a boiling water feature only, and does not need to be disabled when dispensing chilled water.

- When the safety lock is enabled :
- Exclamation mark is extinguished.
- Safety lock is illuminated.

Boiling

Boiling chilled

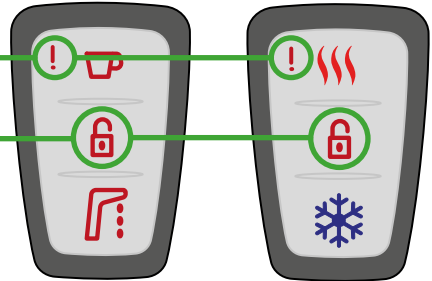

- To disable the safety lock :
- Press safety lock.
- All icons illuminate.
- The safety lock is disabled.

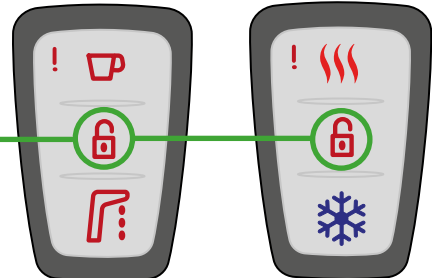

- Press any boiling water dispense button (within 5 seconds of disabling the safety lock) to dispense water.

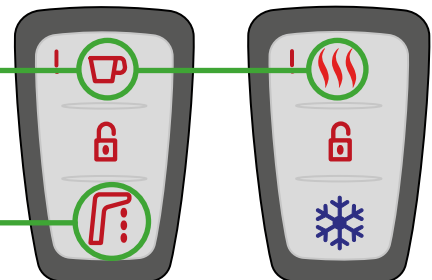

- Following dispense, the safety lock automatically re-enables.
- Safety lock illuminates.

### 8.3 Dispense boiling water from the UCB



- Make sure the InstaTap is switched on and ready to use, see page 20.
- Familiarise yourself with the tap control icons, section 8.1 Tap controls.
- Check that the tap control safety lock icon is illuminated.
- To manually dispense boiling water, place cup on font.
- Press the safety lock.

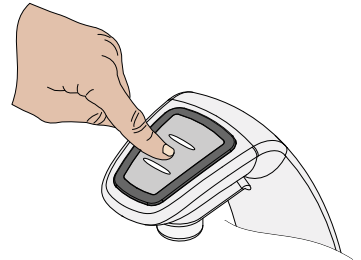

- Press the chosen icon to dispense.
- CAUTION HOT WATER flashes on the UCB display screen during boiling water dispense.

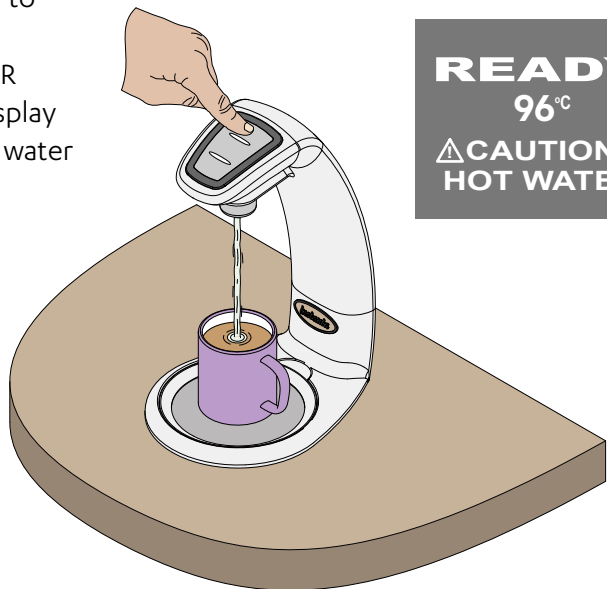



### 8.4 Dispense chilled water from the UCC

- Make sure the InstaTap is switched on and ready to use, see page 20.
- Familiarise yourself with the tap control icons, section 8.1 Tap controls.
- To manually dispense chilled water, place glass or jug on front.
- Press the chilled icon to dispense.

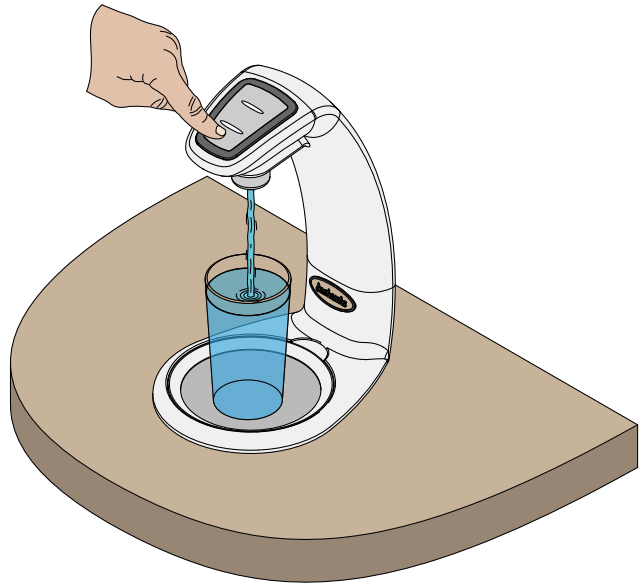

### 8.5 Adjust the chilled water flow rate from the UCC

- The chilled water flow rate has been factory set, however on-site adjustment may be necessary. The water flow-rate adjustment knob is on the top of the UCC, see page 17.
- To adjust, pull valve adjuster upwards.
- Turn clockwise to increase, Anti-clockwise to reduce.
- As a guide, a small glass (180ml) should take approximately 5 seconds to dispense.
- **Note** If the flow-rate is faster than this, water passes through the cooling block too quickly and dispensed water may not be as cool as specified.

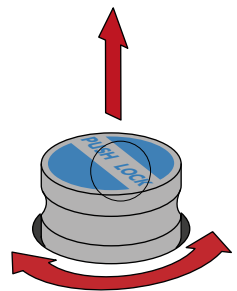

### 8.6 Set up the fixed volume dispense



- This function is useful when the cup/teapot being filled is always the same size/capacity.
- To change from on-demand dispense (default) to set volume dispense :
- Switch off under counter boiler (UCB) using ON/OFF button.
- Switch OFF mains power supply and wait 10 seconds.
- Switch back ON and at the same time, press & hold the bottom dispense button (on the tap) for 5 seconds.
- The tank will either start to fill with water or the dispense button will begin to flash (depending on water level in tank).
- Screen flashes alternate red white
- Release the dispense button.
- The display will show the ready screen (unless tank is filling).
- Press the relevant fixed volume dispense button, & hold until filled with the desired volume).
- Don't take finger off, until desired volume is dispensed.
- Press the bottom dispense button to save the measured volume (the appliance will switch OFF).
- Switch the appliance on again using the ON/OFF button on the front panel of the UCB.
- The set volume has now been programmed.

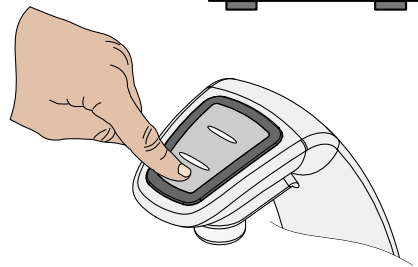
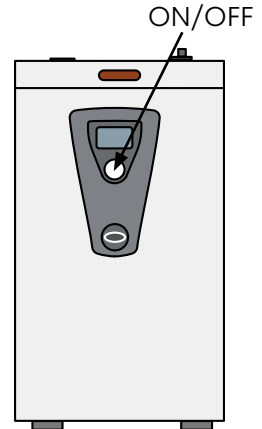

### 9.1 Replace ,flush and reset the filter



Not changing the filter cartridge when required may affect the water quality.

Sanitisation should be carried out at all filter changes, or at intervals of no more than 12 months.



Use instructions supplied with the filter cartridge.

#### 9.1.1 Replace the FL500 filter

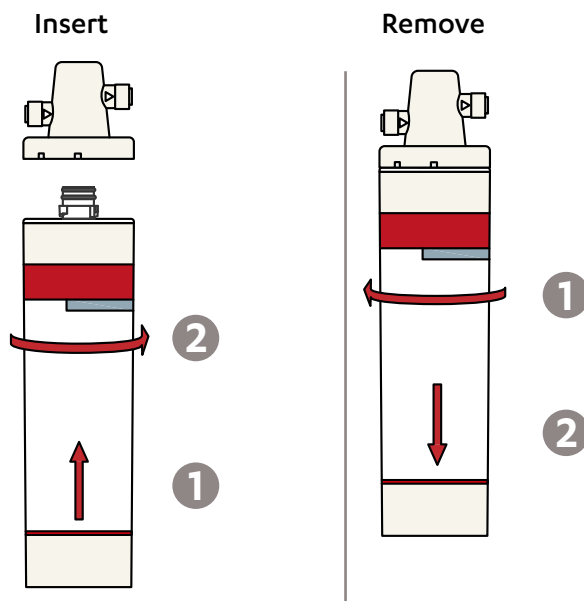

- Turn OFF the power supply to the UCB and UCC appliances.
- Turn OFF the (mains water supply) isolation valve on the install rail.
- Remove the old filter (see above).
- Be aware that some water may drip from the filter head.
- Remove the sanitary cap from the new filter, do not touch the connector .
- Moisten the new filter connector with clean tap water.
- Insert the new filter (see above).
- Flush the filter, see page 28.
- Reset the filter monitor, see page 30.

## SECTION 9 Maintenance

### 9.1.2 Flush the filter

- Turn OFF the power supply to the under counter appliances.
- Turn OFF the water supply to the under counter appliances with the isolation valve on the install rail.
- Disconnect the water supply hose to the UCB.
- Direct the UCB water supply hose into a sink or suitable container.

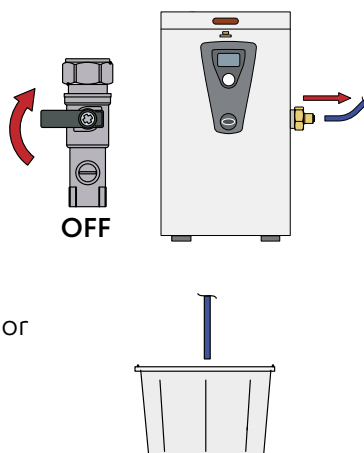

- Turn ON the isolation valve on the install rail.
- Flush the new filter with the volume of water stated in the instructions supplied with the filter - usually a minimum of 10 litres.
- Be aware, depending on the water block setting, it may trip and need to be reset during the flushing process, see page 16.

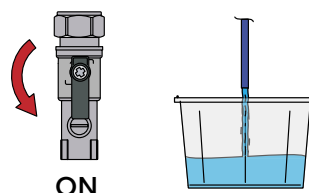

- Turn OFF the isolation valve.
- Reconnect the mains supply hose to the UCB.

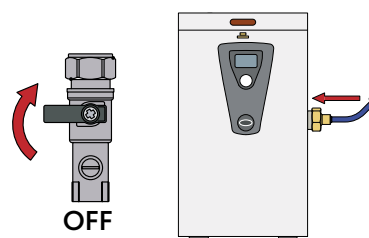

- Turn ON the water supply to the under counter appliances with the isolation valve.
- Turn ON the power supply to the under counter appliances.

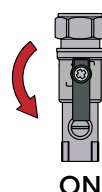

### 9.1.3 Adjust the UCB boiling water temperature

- The temperature of water in the tank can also be adjusted during the same procedure as the filter monitor.
- Turn OFF the under counter boiler with the ON/OFF button.
- Press & hold ON/OFF button (approx. 12 seconds).

ON/OFF button

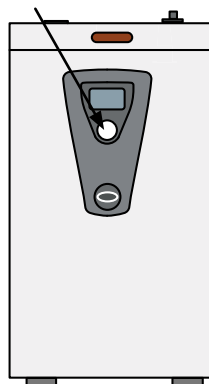

- The display screen shows the Pr icon.
- Release the ON/OFF button.

Pr

### 9.1.4 Set the temperature

- After releasing the ON/OFF button (above the temperature setting is displayed).
- Press ON/OFF button incrementally to adjust the temperature by 1°C per increment.
- The adjustment will increase the temperature, to set a lower temperature, continue to cycle through the range.

96°C

### 9.1.5 Set up the UCB filter monitor

- The under counter boiler has different settings for SOFT, MEDIUM & HARD water conditions.
- The filter monitor is factory-set to MEDIUM which is suitable for most parts of the UK with average or medium water hardness.
- The effectiveness of the filter will be reduced in hard water areas (and should be replaced more frequently), or extended in soft water areas where lime-scale is less of a problem.
- If in doubt as to the hardness of water supplied in your area, consult your local water authority or call Technical Support on 0345 6 005 005.
- Change from the default MEDIUM setting to HARD or SOFT setting as follows:
  - Replace and flush the filter, see page 27-28.
  - Continuing on from the temperature setting screen.
  - Press & hold ON/OFF button (long push) for approximately 5 seconds until screen changes to show “medium” (default filter setting).
  - Press ON/OFF button (short push) to scroll between the different filter settings.
    - SOFT
    - MEDIUM
    - HARD
    - EMPTY FILTER  (no filter monitor).

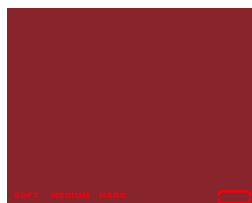
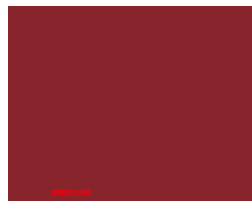

- With the required filter setting selected, press & hold ON/OFF button (long push) for 4 seconds to save.
- Press & hold ON/OFF button (long push) for approximately 6 seconds until display goes blank.
- Press ON/OFF button to turn the UCB5 back on again.

### 9.2 Cleaning



Cleaning of the tap and dispensing outlets must only be undertaken with alcohol or sanitising wipes.

Chemicals should **NOT** be sprayed onto the Tap or UCB / UCC at any time. Never use strong, corrosive or abrasive cleaning materials on the InstaTap Tap or UCB / UCC.





**This could cause permanent malfunction and void warranty.**

- To clean tap, font, under-counter appliance and ancillaries, wipe surfaces with a sanitising wipe and leave to air dry.

## SECTION 10 Service warnings and troubleshooting

### 10.1 Troubleshooting

- The UCB is fitted with an intelligent fault diagnosing system and is able to detect various fault conditions. Some of these are less serious and it will continue to operate as normal, while others are more serious and will cause the UCB to be disabled.

	Non functional warnings	Possible causes	Action
		Water turned off. Inlet hose kinked or bent. Low in-coming water pressure.	Check water supply and isolation valve Check in-coming water is at minimum of 2-bar.
		Low-water level probe scaled up.	De-scale inside of tank and level sensors.
		Normal operating probe scaled up.	De-scale level sensors.
Flashing		Over-boiled (due to excessive lime-scale in tank). Faulty Element. Thermistor disconnected, wires cut or faulty. Boil-dry safety switch tripped or faulty.	De-scale tank and level sensors. Isolate machine and wait 10mins, then turn back on again. Reduce temperature setting. Call service if fault persists.
Flashing		Thermistor disconnected, wires cut or faulty.	Call service



## SECTION 10 Service warnings and troubleshooting

- Before calling for service, switch the appliance off at the mains supply and then switch back on after 10 minutes.
- If the fault does not clear, call technical support for advice on 0345 6 005 05.

### Waste electrical and electronic equipment

- The symbol above means that according to United Kingdom and European Union member countries laws and regulations, your product and/ or its battery shall be disposed of separately from household waste.
- When this product reaches its end of life, take it to a collection point designated by local authorities. The separate collection and recycling of your product and/ or its battery at the time of disposal will help conserve natural resources and ensure that it is recycled in a manner that protects human health and the environment.

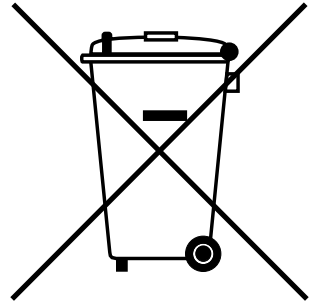

### Warranty

- The appliance is guaranteed for two years from date of installation.
- Our guarantee includes on site labour and parts for problems caused by fault of manufacture and component failure with the following exclusions:
- Problems caused by hard water and limescale. We regret that we cannot be held responsible for problems caused by hard water.
- Accidental damage, misuse or use not in accordance with these instructions and damage caused by incorrect installation.
- The manufacturer disclaims any liability for incidental, or consequential damages.
- For more information please refer to the online [Instanta Warranty Policy](#).



**Zip Water UK**  
**Instanta**  
Trafalgar House,  
Rash's Green, Dereham,  
Norfolk, NR19 1JG  
0345 6 005 005  
[www.zipwater.co.uk](http://www.zipwater.co.uk)  
[www.instanta.com](http://www.instanta.com)

